

Core cross reference (x = material variation within a size)

| | | |
|-------------|--------------|------------|
| Fair-Rite: | Micrometals: | Magnetics: |
| Nicera: | Epcos: | MMG: |
| Ferroxcube: | TDK: | |

Winding Area
(mm²)

LODESTONE PACIFIC
B-EI30H-12-1-PH3

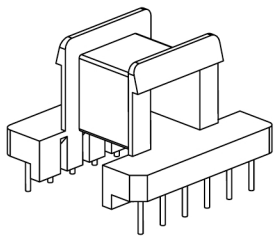

TOP

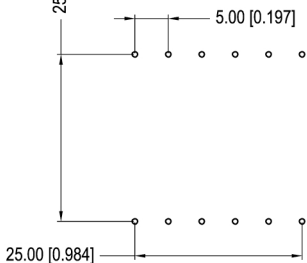
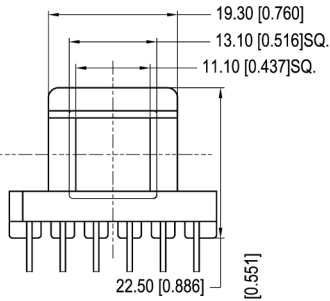
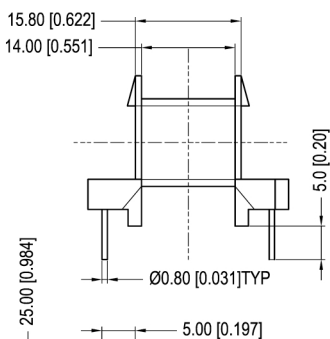
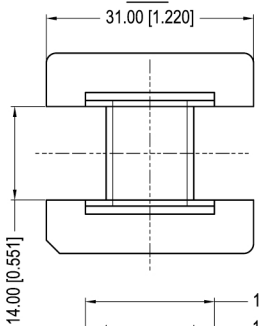

BOTTOM

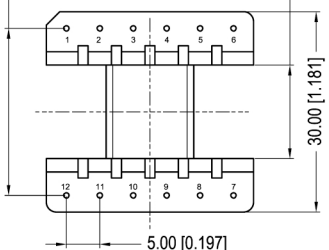

© 2006

| | | | | | | | | |
|---|-------|---------------------------|-------------------------|------------------|------------------|-------------------|---------------|----------|
| | Scale | Tolerance (Inches) | Tolerance (mm) | No. of Terminals | Terminal Plating | Terminal Material | Terminal Type | |
| | None | .XXX ± .008 .XX ± .012 | .XX ± 0.20 .X ± 0.30 | 12 | 100% Tin | CP WIRE | Through Hole | |
| <p style="text-align: center;">LODESTONE PACIFIC</p> <p>Phone: (714)970-0900. Fax: (714)970-0800 4769 Wesley Drive, Anaheim, California, 92807, USA Web: www.lodestonepacific.com E-Mail: sales@lodestonepacific.com</p> | | | | | Molding Material | UL File No. | Rating | Class |
| | | | | | PHENOLIC | E59481 | UL94-VO | F |
| Lodestone's Part Number | | | | | | | | Rev. |
| B-EI30H-12-1-PH3 | | | | | | | | 1 |