

Core cross reference (x = material variation within a size)

Fair-Rite: None	Micrometals: None	Magnetics: NX-41510-UG
Nicera: FRM-5	Epcos: B65805	MMG: 29-7XX-XX
Ferroxcube: RM5-XXX-XXXX	TDK: XXXXRM5Z-XX	

Winding Area
(mm²)
2X4.15

LODESTONE PACIFIC
B-RM5-4-2-PH

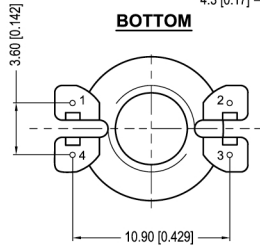
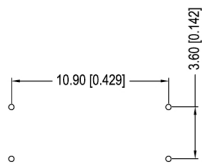
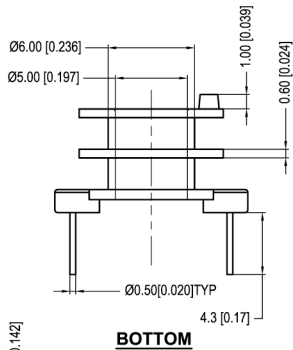
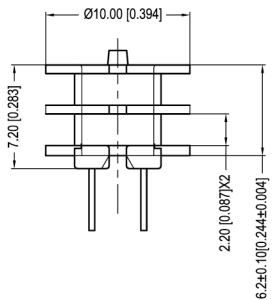
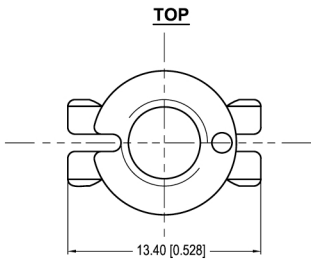
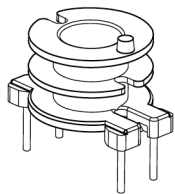

© 2006

	Scale	Tolerance (Inches)	Tolerance (mm)	No. of Terminals	Terminal Plating	Terminal Material	Terminal Type		
	None	.XXX ± .008 .XX ± .012	.XX ± 0.20 X ± 0.30	4	100% Tin	CP WIRE	Through Hole		
<p style="text-align: center;">LODESTONE PACIFIC</p> <p>Phone: (714)970-0900, Fax: (714)970-0800 4769 Wesley Drive, Anaheim, California, 92807, USA Web: www.lodestonepacific.com E-Mail: sales@lodestonepacific.com</p>						Molding Material	UL File No.	Rating	Class
						Phenolic	E41429	UL94-VO	N
Lodestone's Part Number									
B-RM5-4-2-PH									
Rev. 1									