

Core cross reference (x = material variation within a size)

Fair-Rite: None	Micrometals: None	Magnetics: NX-41812-UG
Nicera: FRM-6	Epcos: B65807	MMG: 29-730X-XX
Ferroxcube: RM6S-XXX-XXXX	TDK: XXXXRM6Z-XX	

Winding Area (mm<sup>2</sup>)  
**2X7**

LODESTONE PACIFIC  
**B-RM6-6-1-PH2**

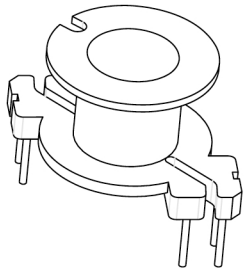

**TOP**

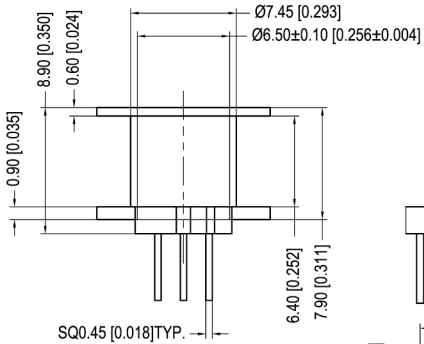
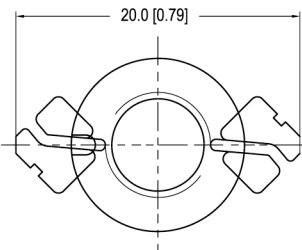

**BOTTOM**

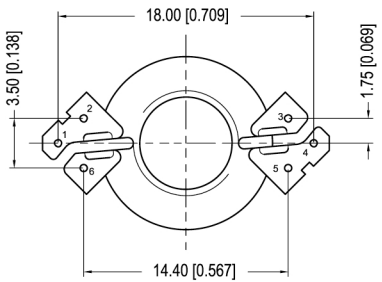
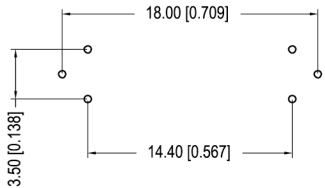
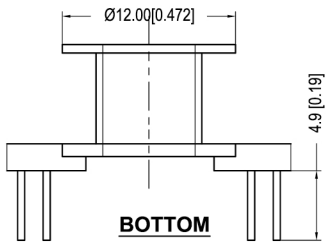

© 2006

	Scale	Tolerance (Inches)	Tolerance (mm)	No. of Terminals	Terminal Plating	Terminal Material	Terminal Type	
	None	.XXX ± .008 .XX ± .012	.XX ± 0.20 .X ± 0.30	6	100% Tin	CP WIRE	Through Hole	
<p style="text-align: center;"><b>LODESTONE PACIFIC</b></p> <p>Phone: (714)970-0900. Fax: (714)970-0800 4769 Wesley Drive, Anaheim, California, 92807, USA Web: www.lodestonepacific.com E-Mail: sales@lodestonepacific.com</p>					Molding Material	UL File No.	Rating	Class
					Phenolic	E41429	UL94-V0	N
Lodestone's Part Number							Rev.	
<b>B-RM6-6-1-PH2</b>							<b>1</b>	