

Core cross reference (x = material variation within a size)

Fair-Rite: 65XX131321	Micrometals: None	Magnetics: XX-41313-UG
Nicera: FEP-13	Epcos: B65843	MMG: 32-800-XX
Ferroxcube: EP13-XXX-XXXX	TDK: XXXEP13-Z	

Winding Area  
(mm<sup>2</sup>)  
13.8

LODESTONE PACIFIC  
**SMB-EP13-10-1-LCP**



**TOP**

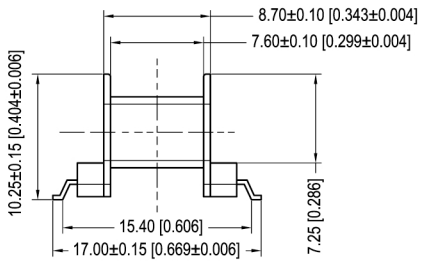
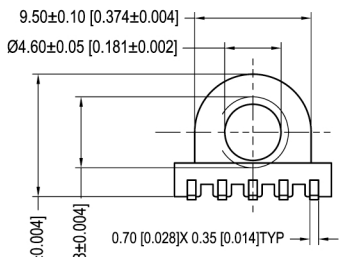
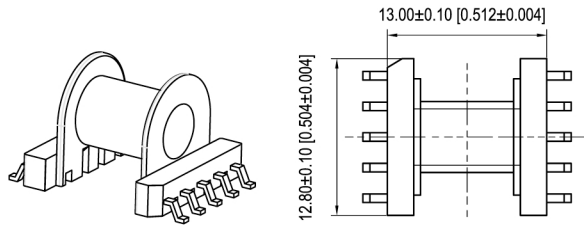

**BOTTOM**

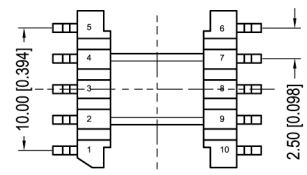
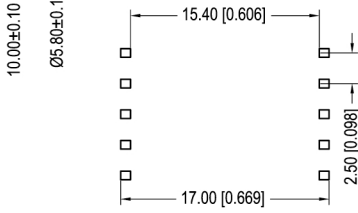

© 2006

	Scale	Tolerance (Inches)	Tolerance (mm)	No. of Terminals	Terminal Plating	Terminal Material	Terminal Type	
	None	.XXX ± .008 .XX ± .012	.XX ± 0.20 .X ± 0.30	10	100% Tin	Phosphor Bronze	Surface Mount	
<p style="text-align: center;"><b>LODESTONE PACIFIC</b></p>					Molding Material	UL File No.	Rating	Class
					LCP	E54705	UL94-VO	F
Lodestone's Part Number							Rev.	
<b>SMB-EP13-10-1-LCP</b>							<b>1</b>	

Phone: (714)970-0900. Fax: (714)970-0800  
4769 Wesley Drive, Anaheim, California, 92807, USA  
Web: www.lodestonepacific.com E-Mail: sales@lodestonepacific.com