

Core cross reference (x = material variation within a size)

Fair-Rite: 65XX131321	Micrometals: None	Magnetics: XX-41313-UG
Nicera: FEP-13	Epcos: B65843	MMG: 32-800-XX
Ferroxcube: EP13-XXX-XXXX	TDK: XXXEP13-Z	

Winding Area  
(mm<sup>2</sup>)

LODESTONE PACIFIC  
**SMB-EP13-10-2-LCP**



**TOP**

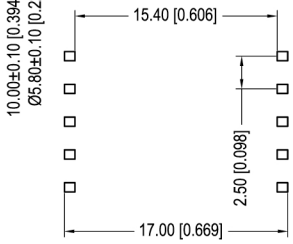
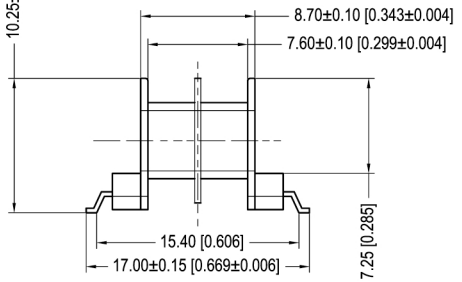
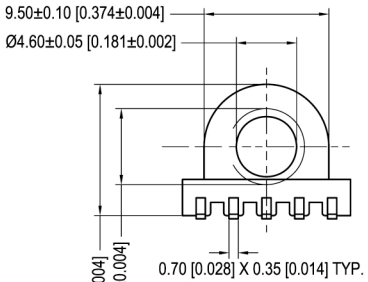
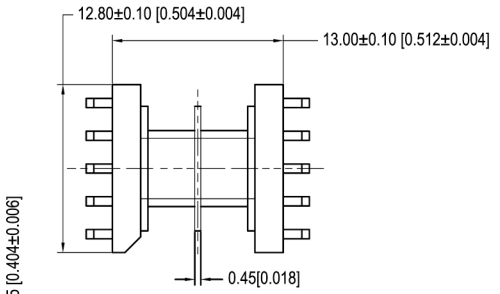
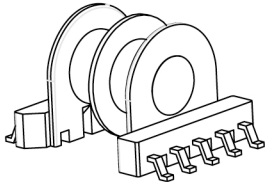

**BOTTOM**

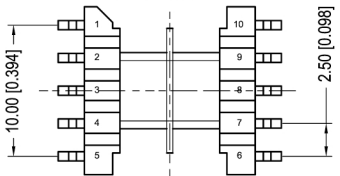

© 2006

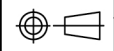

Scale	Tolerance (Inches)	Tolerance (mm)	No. of Terminals	Terminal Plating	Terminal Material	Terminal Type
None	.XXX ± .008 .XX ± .012	.XX ± 0.20 .X ± 0.30	10	100% Tin	Phosphor Bronze	Surface Mount

**LODESTONE PACIFIC**



Phone:(714)970-0900.Fax:(714)970-0800  
4769 Wesley Drive,Anaheim,California,92807,USA  
Web:www.lodestonepacific.com E-Mail:sales@lodestonepacific.com

Molding Material	UL File No.	Rating	Class
LCP	E54705	UL94-VO	F
Lodestone's Part Number			Rev.
<b>SMB-EP13-10-2-LCP</b>			<b>1</b>