

Core cross reference (x = material variation within a size)

Fair-Rite: None	Micrometals: None	Magnetics: None
Nicera: FEER-11/5S	Epcos: B65525	MMG: None
Ferroxcube: ER11-XXX-XXX-S	TDK: XXXXER11/5-Z	

Winding Area
(mm²)
2.8

LODESTONE PACIFIC
SMB-ER11.5-10-1-PH

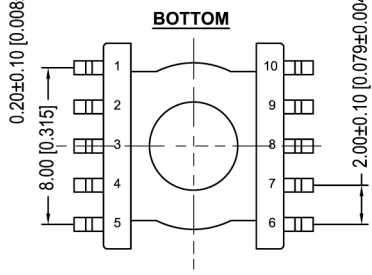
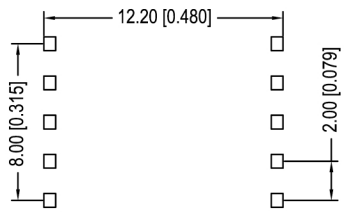
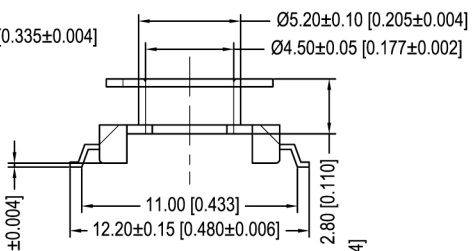
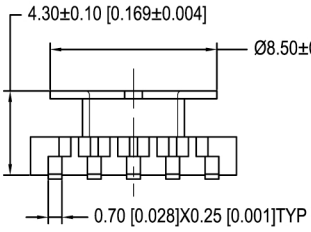
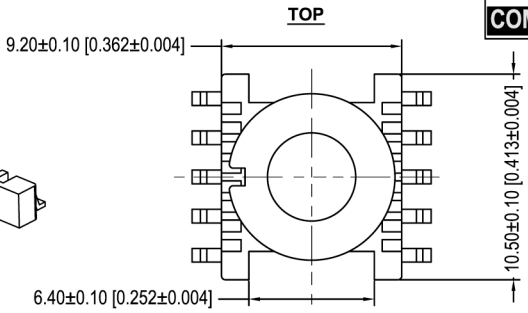
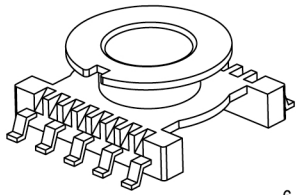

© 2006

	Scale	Tolerance (Inches)	Tolerance (mm)	No. of Terminals	Terminal Plating	Terminal Material	Terminal Type	
	None	.XXX ± .008 .XX ± 0.12	.XX ± 0.20 .X ± 0.30	10	100% Tin	Phosphor Bronze	Surface Mount	
<p style="text-align: center;">LODESTONE PACIFIC</p> <p>Phone: (714)970-0900. Fax: (714)970-0800 4769 Wesley Drive, Anaheim, California, 92807, USA Web: www.lodestonepacific.com E-Mail: sales@lodestonepacific.com</p>					Molding Material	UL File No.	Rating	Class
					Phenolic	E41429	UL94-VO	N
Lodestone's Part Number							Rev.	
SMB-ER11.5-10-1-PH							1	