

Core cross reference (x = material variation within a size)

Fair-Rite: None	Micrometals: None	Magnetics: None
Nicera: FEER-14.5/6	Epcos: B65513	MMG: None
Ferroxcube: None	TDK: H5C2ER14.5/6-Z	

Winding Area  
(mm<sup>2</sup>)  
**5.1**

LODESTONE PACIFIC  
**SMB-ER14.5-10-1-PH**

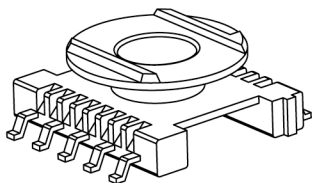

**TOP**

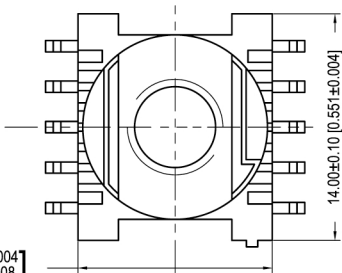

$12.00^{+0.10}_{-0.20} [0.472^{+0.004}_{-0.008}]$

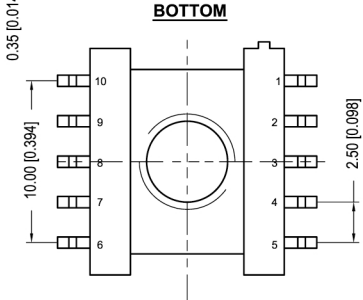
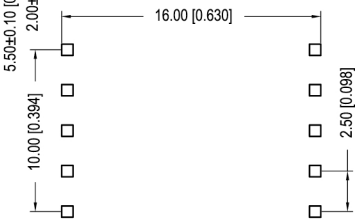
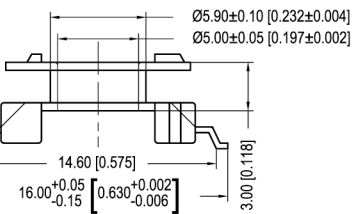
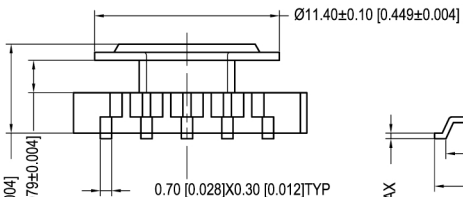

**BOTTOM**

© 2006



Scale	Tolerance (Inches)	Tolerance (mm)	No. of Terminals	Terminal Plating	Terminal Material	Terminal Type
None	.XXX ± .008 .XX ± .012	.XX ± 0.20 .X ± 0.30	10	100% Tin	Phosphor Bronze	Surface Mount

**LODESTONE PACIFIC**



Phone: (714)970-0900, Fax: (714)970-0800  
4769 Wesley Drive, Anaheim, California, 92807, USA  
Web: www.lodestonepacific.com E-Mail: sales@lodestonepacific.com

Molding Material	UL File No.	Rating	Class
Phenolic	E41429	UL94-VO	N
Lodestone's Part Number			Rev.
<b>SMB-ER14.5-10-1-PH</b>			<b>1</b>