

Core cross reference (x = material variation within a type)

Fair-Rite: None	Micrometals: None	Magnetics: X-40906-EC
Nicera: FEER-9.5/5	Epcos: B65523	MMG: None
Ferroxcube: ER9.5-XXX-XXX-S	TDK: XXXXER9.5/5-Z	

Winding Area
(mm²)
2.8

LODESTONE PACIFIC
SMB-ER9.5-8-1-PH

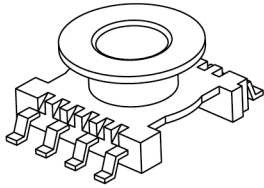

TOP

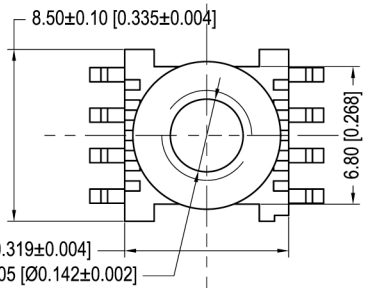

Ø7.30±0.10 [0.287±0.004]
Ø4.45±0.10 [0.175±0.004]

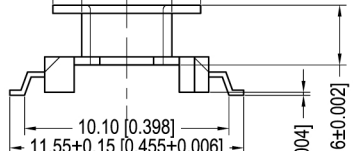
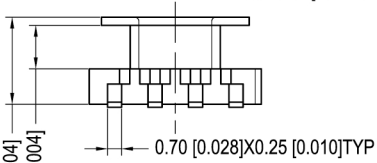

BOTTOM

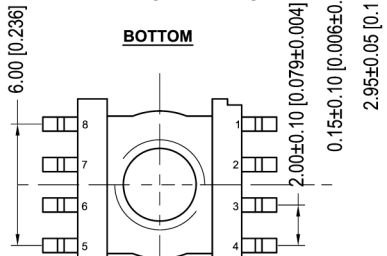
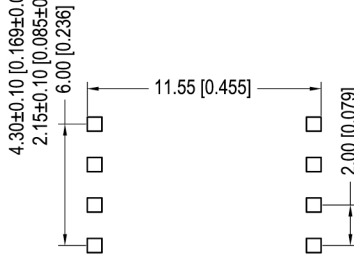

© 2006

	Scale	Tolerance (Inches)	Tolerance (mm)	No. of Terminals	Terminal Plating	Terminal Material	Terminal Type	
	None	.XXX ± .008 .XX ± 0.12	.XX ± 0.20 X ± 0.30	8	100% Tin	Phosphor Bronze	Surface Mount	
<p style="text-align: center;">LODESTONE PACIFIC</p> <p>4769 Wesley Drive, Anaheim, California, 92807, USA Phone: (714)970-0900, Fax: (714)970-0800 Web: www.lodestonepacific.com E-Mail: sales@lodestonepacific.com</p>					Molding Material	UL File No.	Rating	Class
					Phenolic	E41429	UL94-VO	N
<p style="text-align: center;">Lodestone's Part Number</p> <p style="text-align: center;">SMB-ER9.5-8-1-PH</p>							Rev.	
							1	