

**Core cross reference (x = material variation within a size)**

Fair-Rite: None	Micrometals: None	Magnetics: NX-41812-UG
Nicera: FRM-6	Epcos: B65807	MMG: 29-730X-XX
Ferroxcube: RM6S-XXX-XXXX	TDK: XXXXRM6Z-XX	

Winding Area (mm <sup>2</sup> )	LODESTONE PACIFIC
2X7	<b>SMB-RM6-8-1-LCP-C</b>

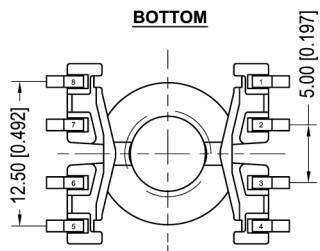
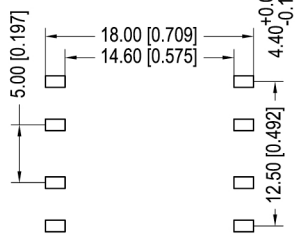
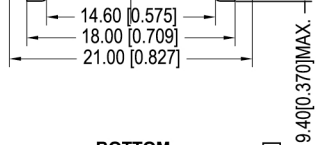
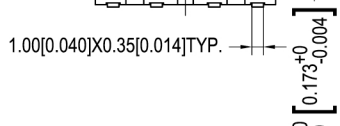
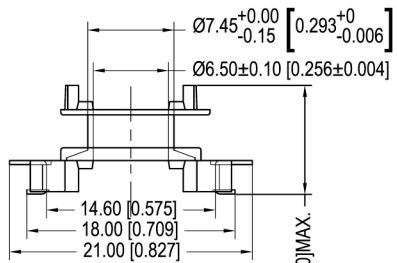
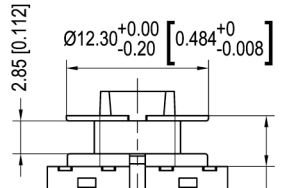
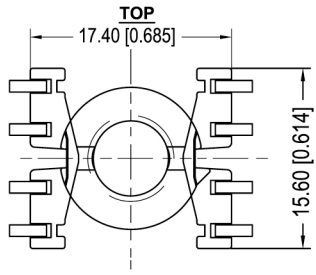
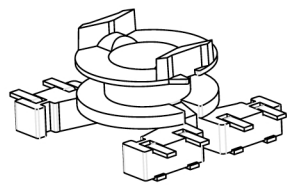

© 2006

	Scale	Tolerance (Inches)	Tolerance (mm)	No. of Terminals	Terminal Plating	Terminal Material	Terminal Type	
	None	.XXX ±0.08 .XX ±.012	.XX ±0.20 .X ±0.30	8	100% Tin	Phosphor Bronze	C Type	
					Molding Material	UL File No.	Rating	Class
					LCP	E54705	UL94-V0	F
Lodestone's Part Number							Rev.	
<b>SMB-RM6-8-1-LCP-C</b>							<b>1</b>	

Phone: (714)970-0900 Fax: (714)970-0800  
 4769 Wesley Drive, Anaheim, California, 92807, USA  
 Web: www.lodestonepacific.com E-Mail: sales@lodestonepacific.com